

HMSPACES HEATING SHOES USER MANUAL



Introduction

HMSPACES Heating Shoes is an invisible electric heated shoes. The heel has a built-in safety lithium battery as heating shoes energy, and insoles are built-in high-quality electric heating wire, in order to make the shoes insoles to be safety and comfort, the electric heating wire is designed to be small, water-resistance, corrosion-resistance and anti-extrusion. The entire heating equipment is hidden inside of the shoes, so the shoes appearance is nice-looking. The sole uses a combination of new MD + RB material, which makes the shoes light weight and antiskid. With the equipped infrared remote control, you can turn on/off the heating function at any time.

The heating shoes are designed for all kinds of people to keep feet warm and prevent chilblain in cold weather. Meanwhile we conducted a variety of extreme product testing to ensure the safety of use.

Please read this manual carefully and enjoy yourself.

Safety test



The hit testing for battery

There is a battery pack inside the heel of each shoe, in order to ensure the battery can withstand the impact of walking or jumping in daily use, we performed 10,000 hit testing for each battery back.

Safety test



The pressure testing for battery

There is a battery pack inside the heel of each shoe, in order to ensure the battery can withstand the pressure of body weight in daily use, we performed car pressure testing for each battery back.

Safety test



The water-resistance testing

The entire circuit is water-resistance design. The shoes can be washed and charged underwater. In order to ensure the safety of circuit, we performed a month of underwater testing for each circuit.

What is in the box

- A pair of heating shoes
- A power adapter
- A magnetic type of USB charge cord
- A remote controller

Learn about controller

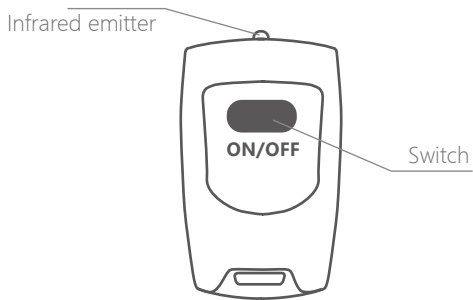

Learn about heating shoes

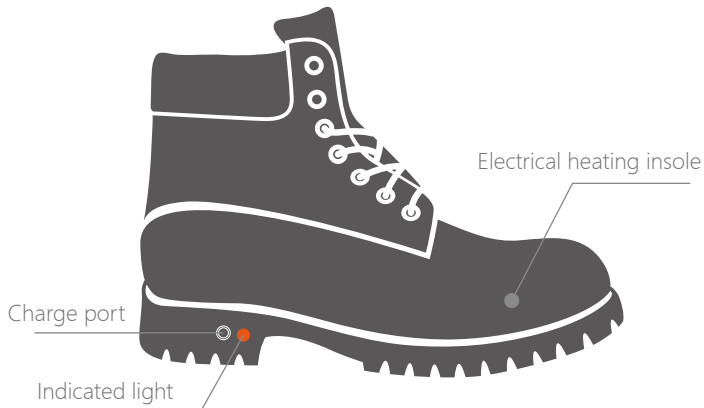

Charging operations



- 1 Connect the power source to the charge port of shoes.
- 2 The indicated light starts flashing in red color.

During charging process

- **Self-drying.** The first 30 minutes heating shoes will heat the shoes to 60 degrees to dry the interior and sterilization.
- 30 minutes later the heating shoes will switch to full power charging. The shoes will stop charging until the indicated light becomes constant red color. Charging duration may last about 8 hours.





🔦 Indicated light status	
Flashing in red color	Constant red color
The battery is charging	The battery gets a full charge

Heating operations



- 1 One-click ON/OFF button to turn on high temperature electrical heating function.
- 2 One-click again ON/OFF button to switch to low temperature electrical heating function.
- 3 One-click again ON/OFF button to turn off electrical heating function.

 TIPS: Turn on the electrical heating when feeling cold, and turn off it when feeling warm, the shoes' batteries charge will last longer.

 Indicated light status		
 Red light on	 Blue light on	 Red light off
The shoes is full power heating Heat to 60°C (+140°F) Max heating time: 8 hours	The shoes is low power heating Heat to 45°C (+113°F) Max heating time: 10 hours	The shoes stops heating

Cautions

- ⚠ This heating shoes' batteries, electronic systems and heating chips are waterproof and insulation protection, it can adapt to the humid environment, but do not soak shoes in water for a long time to prevent deformation of shoes and comfort deteriorates.
- ⚠ Do not use the heating shoes during charging process.
- ⚠ Beware of metal thorn when using the shoes, or it will damage the electronic systems.
- ⚠ If possible, when the shoes is lay idle, please charge and discharge the shoes one time per a month to keep the batteries active.
- ⚠ Do not disassemble the shoes to avoid damaging the shoes.
- ⚠ Do not take off the insole because it has electrical wire connected to the heel. Strongly take off it will break the electrical circuit.
- ⚠ Please make sure there is no any obstruction between the remote controller and shoes when controlling shoes with the controller. Or the controller will be out of action.

Troubleshooting

Problems in the charging process		
Trouble	Possible cause	Solution
Indicated light is unlit	The plug was loose	Check if the power plug and magnetic plug was loose or not, replug them several times
	The charge cable/battery had problem	Contact the seller to get warranty service
Indicated light is not flashing	The system was not activated	Plug the power source and then activate the system by one-clicking the remote controller
	The batteries get a full charge, no need charging	The indicated light will switch to constant red, use up the battery and re-try again

Problems over the period of use		
Trouble	Possible cause	Solution
The light is unlit after one-clicking the controller	There is obstacle between controller and shoes	Remove the obstacles and use the controller closer to indicated light
	The controller's battery died	Purchase a new button battery from retail store and replace the old one
Not heating at all	The battery died or low power	Plug the power source to charge it immediately
	The battery or circuit had problems	Contact the seller to get warranty service



HMS PACES

www.hmspaces.com

Phone: +86 0755 86020195

E-mail: hmspaces@hmspaces.com

Designed in USA, Produced in China

HMS PACES Heating Shoes Specification

Product model: HMS-XX-XX-X

Heating temperature range: 0 to 60°C (32 to 140°F)

Operation temperature: -20 to 70°C (-4 to 158°F)

Max full power heating time(Red light, 60°C/140°F): 8 hours

Max low power heating time(Blue light, 45°C/113°F): 10 hours

IR distance: 2 meters

Input power: 5V , 2A

Power adapter input: AC 100-240V

Power method: Battery

Battery type: Lithium

Battery quantity: 4

Battery weight: per 45g

Charging time: 8 - 9 hours